

# Deploying Power BI...

...without shooting yourself in the foot



Mike Bender  
Head of BI & Analytics @ Alltech



# Today's Agenda

- Mike, Alltech and Power BI
- Overview of the Power BI Ecosystem
- Getting Data into Power BI
- Connecting Data from multiple sources
- Sharing reports to the Power BI service
- Security Considerations for Power BI

DEMO



# Mike Bender: Driving Digital Maturity @ Alltech

IDEATION  
SPACE

IDEATION  
SPACE



## Highlights from Mike's Background

- Joined Alltech in 2016
- Worked at IBM, Lexmark, Emerson Electric
- Founded a Tech Startup before the Internet
- Degrees in Engineering & Computer Science
- Most of Career creating digital products
- Using Data to Deliver Customer Value

Data inputs

Data integration

BI & Reporting

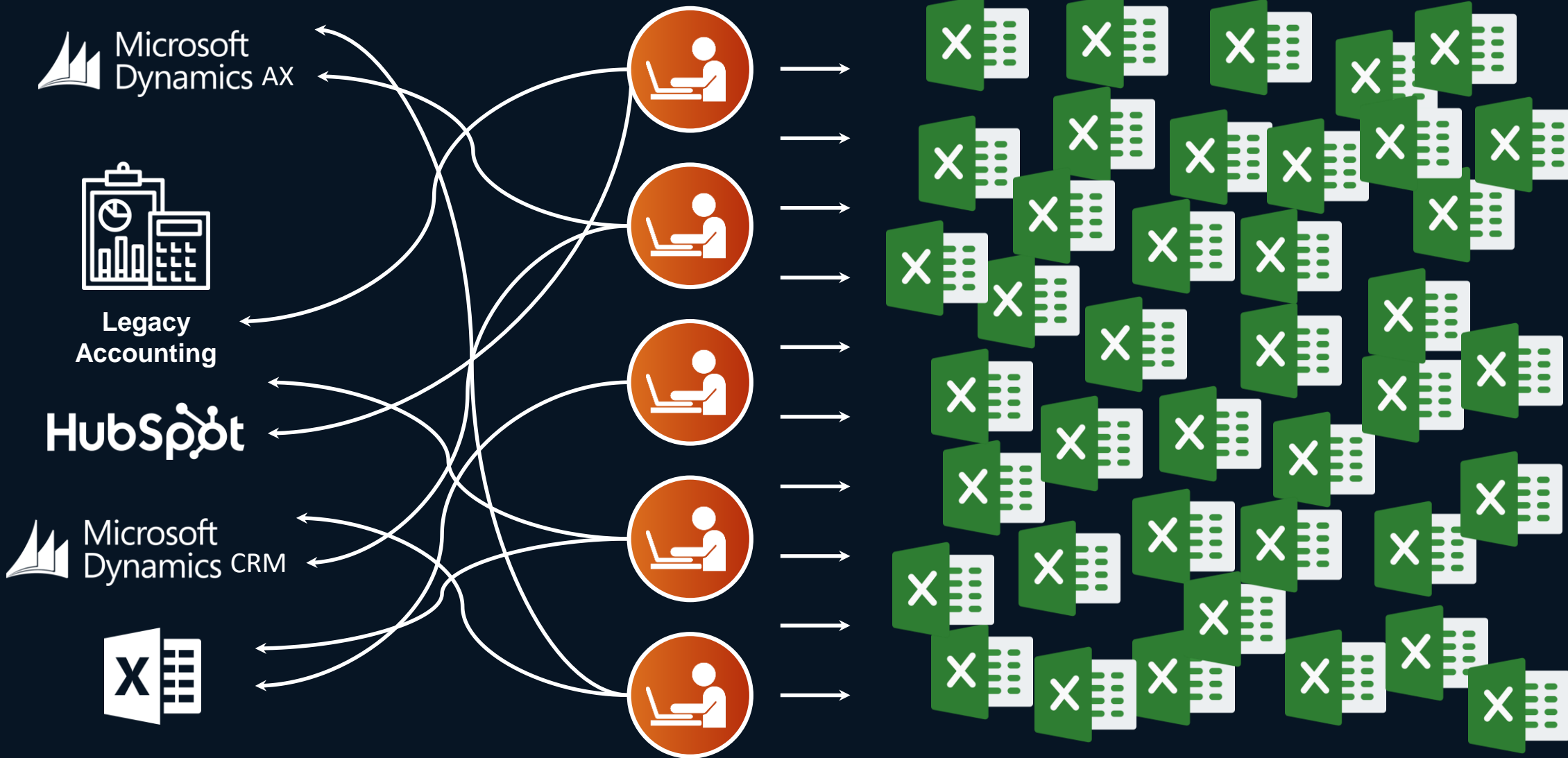

# Turning Data into Business Value

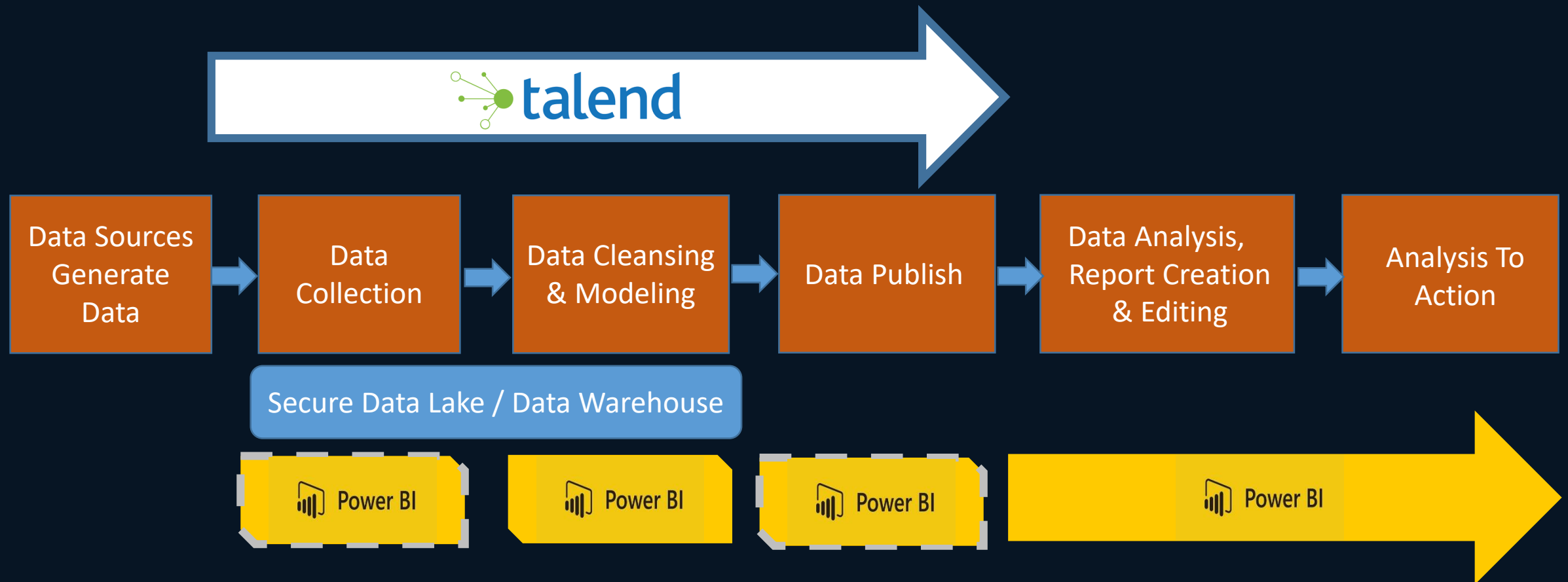

# Microsoft Power BI Ecosystem

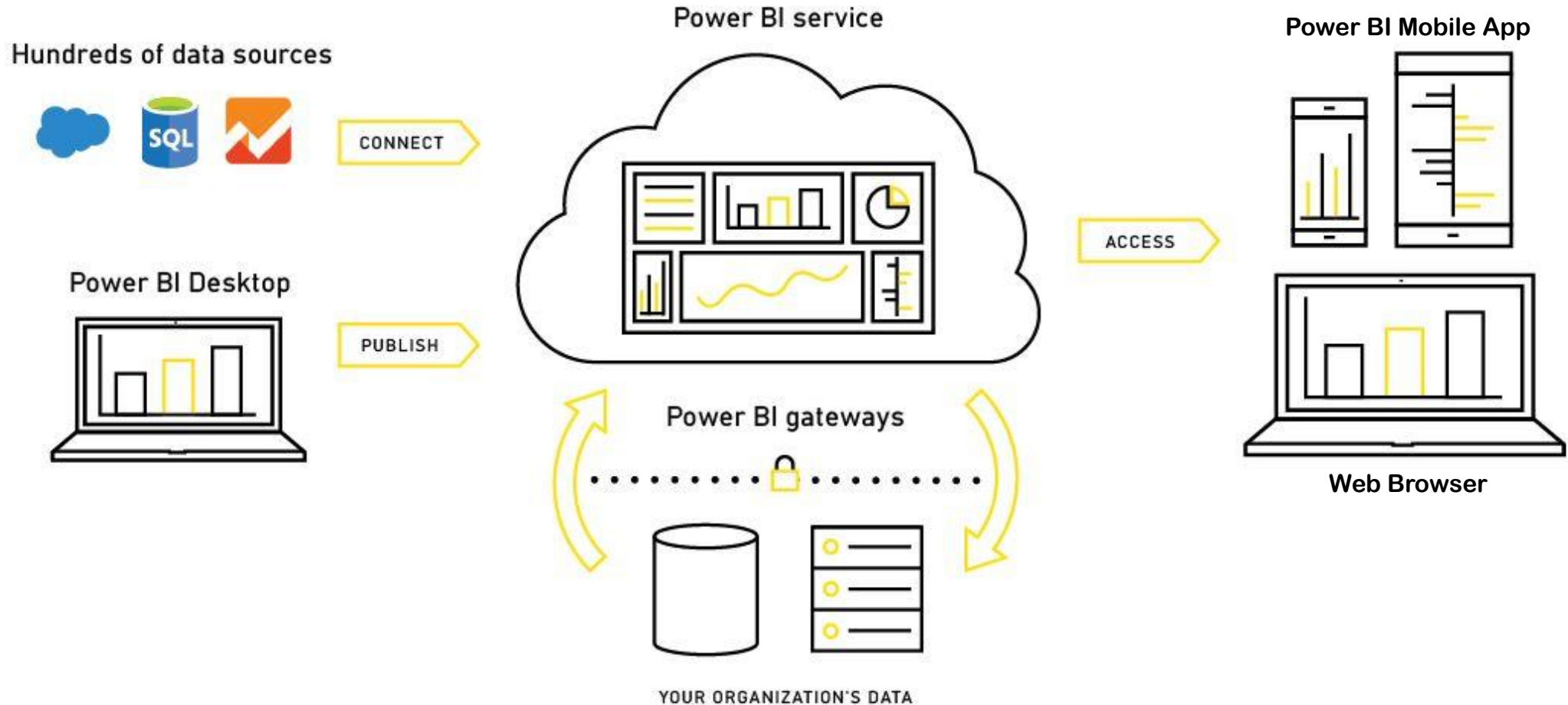

# Today's Demo Scenario

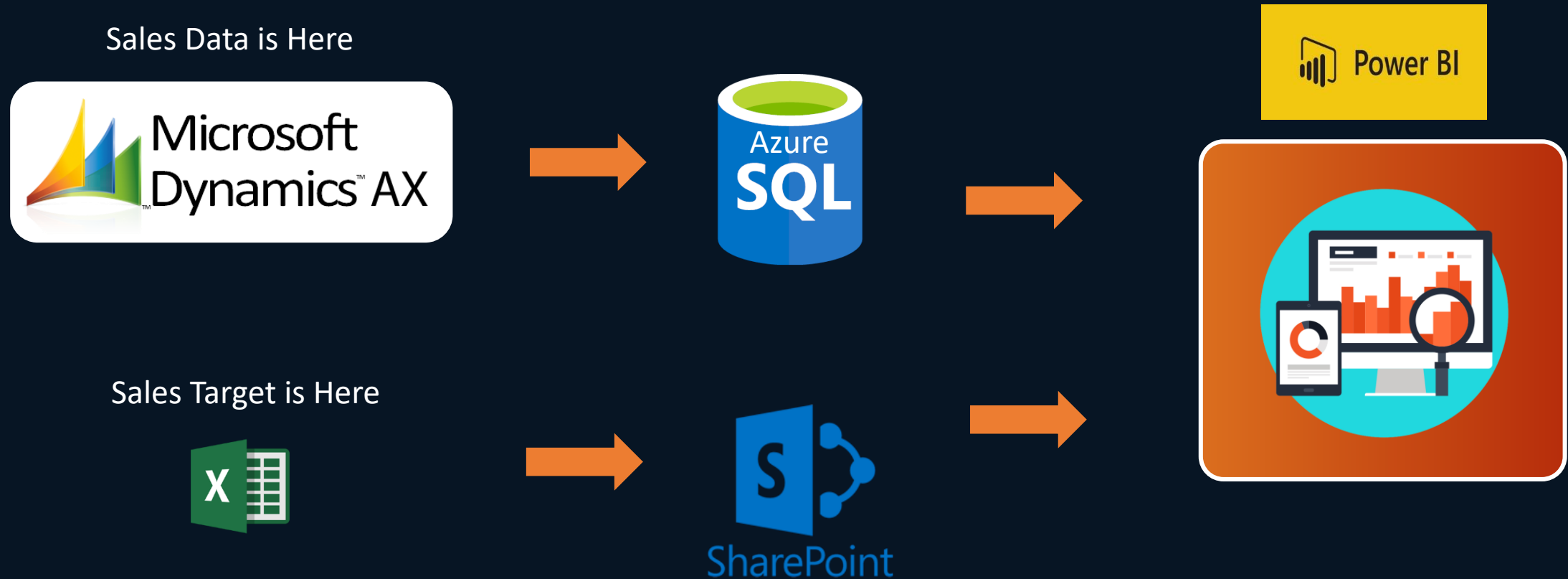

# Publishing Reports to a Workspace

Workspace(s)

Power BI  
Service

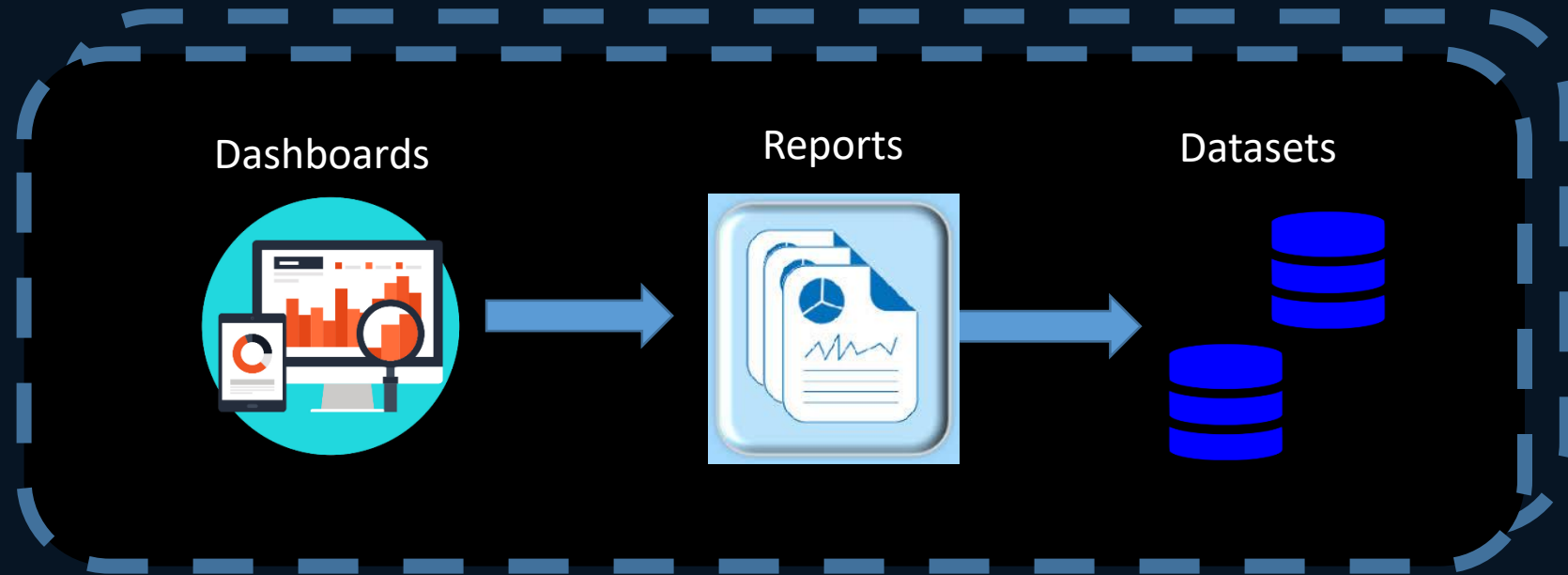

Power BI  
Desktop

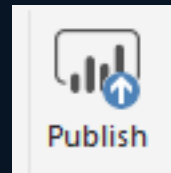
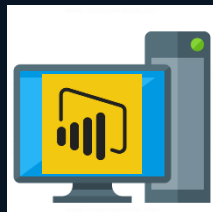



# Sharing Reports and Dashboards

- Share an individual report or dashboard
  - Easy to do
  - Challenging to maintain
- Share a complete workspace
  - Everyone sees everything
  - Control Workspace Naming
- Create and share an App
- Adding Row-level security
- Sharing a published (modeled) data set (new)

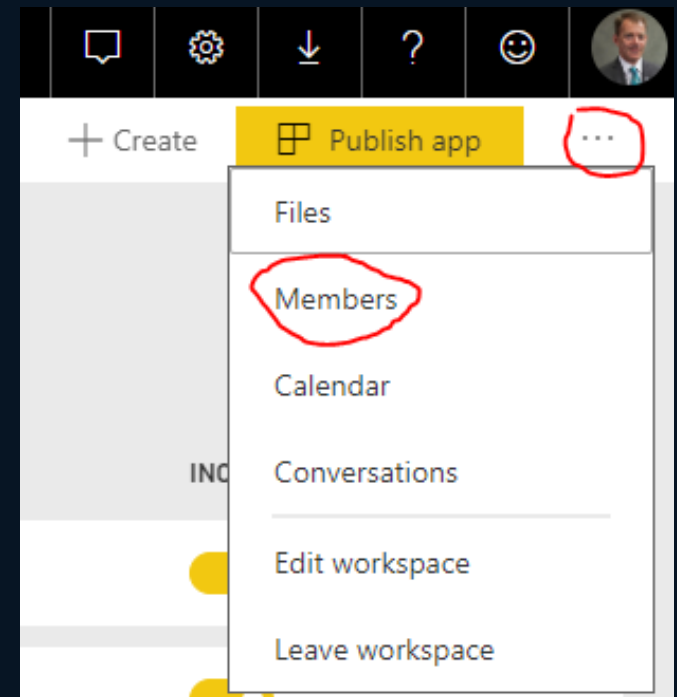

# Other Security Considerations

- Enterprise Tenant Settings
  - Publish to Web - disable for all?
  - Export Data - Limit Export to Excel
  - Allow External Guests
- Disable Export of Underlying Data
- Direct Access to Data Sets
  - Use O365 Security Groups
  - Object level database security



